



CRASH BAR AND ENGINE GUARD

HONDA CRF 300 RALLY

Part Number: H-CRF300RL-17-01 / H-CRF300RL-17-02

Part Description: CRASH BAR AND ENGINE GUARD – HONDA CRF 300 L / 300 RALLY

NO.	Description	Quantity	Torque * (N-M)	Remarks **
1	Bar LH	1		
2	Bar RH	1		
3	Bracket	1		
4	Skid plate	1		
5	Bush OD23xID11xL63.5	1		
6	Bush OD23xID11xL83.5	1		
7	Bush OD23xID12xL27	4		
8	Pin pipe upper	2		
9	Sliders Guards	2		
10	Countersunk Washer M6	6		
11	Socket button head screw M6x15mm	4	9.6	Use Liquid Thread Locker
12	Socket countersunk head screw M6x15	6	9.6	Use Liquid Thread Locker
13	Socket head cap screw M10x180	2	46	Use Liquid Thread Locker
14	Hex bolt gradeb M10x320 (CRF300Rally)	1	46	Use Liquid Thread Locker
15	Hex flange nut M10	2		
16	Washer M6	4		
17	Washer M10	4		
18	Hex nut M10	1		
SRC Design uses Metric System of Measurement and all dimensions in Millimeters				
* Recommended to use the Torque specified in the table				
** Denotes Usage of Liquid Thread Locker in specified Locations				

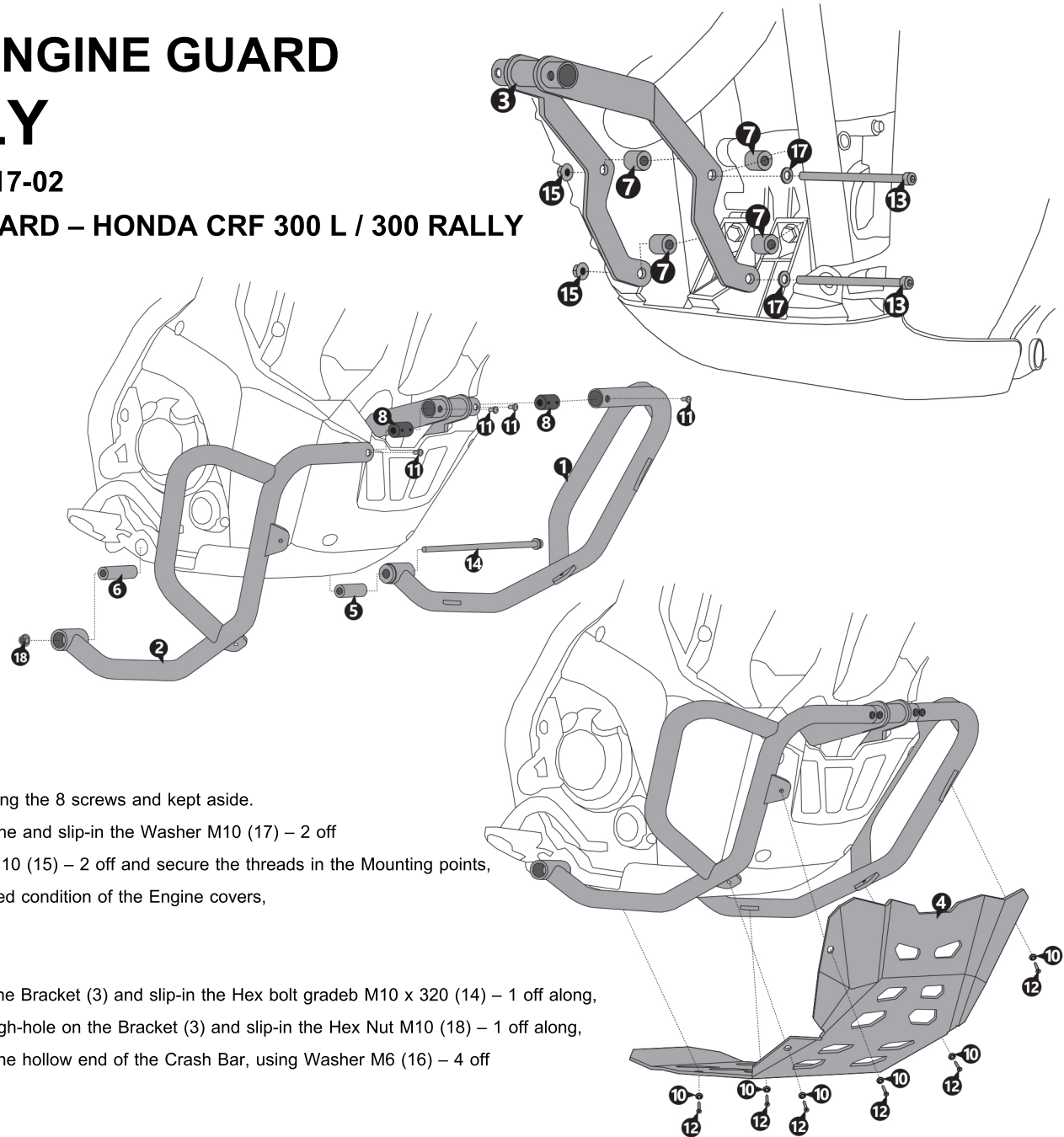

Mounting Instructions

● Step 1:

The Aesthetic cover Front and Under the Engine have to be removed, by unscrewing the 8 screws and kept aside.

Orient and align the Bracket (3) – 1 off, as shown. Slip-in Bush L27 (7) – 4 off in-line and slip-in the Washer M10 (17) – 2 off and pass the Socket head cap screw M10 x 180 (13) – 2 off and Hex flange nut M10 (15) – 2 off and secure the threads in the Mounting points, The Engine covers can be mounted back in their original position. The As is mounted condition of the Engine covers, with the Bracket projecting out for mounting the Crash Bar is shown.

● Step 2:

Orient and align the Crash Bar LH (1), as shown, in-line with the through-hole on the Bracket (3) and slip-in the Hex bolt gradeb M10 x 320 (14) – 1 off along, and secure Orient and align the Crash Bar RH (2), as shown, in-line with the through-hole on the Bracket (3) and slip-in the Hex Nut M10 (18) – 1 off along, and secure insert the Pin Pipe upper (8) – 2 off and secure the Pin pipe upper to the hollow end of the Crash Bar, using Washer M6 (16) – 4 off and Socket Button head screw M6 x 15 (11) – 4 off, as shown.

● Step 3:

Orient the Engine Guard for mounting it to the Side Bracket, as shown. Slip-in the Taper Ring (10) – 6 off and M6 x 15 Screw (12) – 6 off, as shown and secure the threads.

HONDA CRF 300 RALLY