

Bike	Yamaha YZF-R125	Part No.	PYA-113-SYS
Year	2019-Current	Fit Kit	Z039.10653
Notes	Where not supplied use original fittings. Remove OE Gaskets for correct fitment.	dB Killer	SCEXDBK49 - (TYPE PD)

Estimated Fitting Time: 90 Minutes

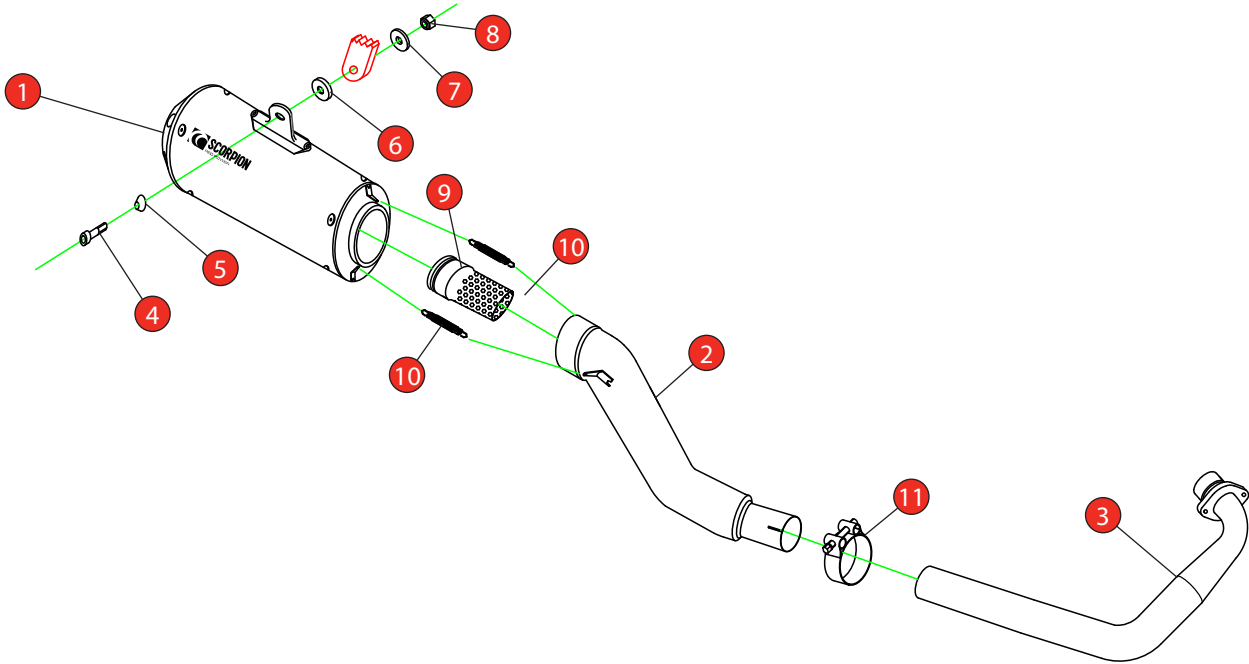

NO.	PART NO.	DESCRIPTION	QTY
1	PSC445	Serket Taper Silencer	1
2	CP1040	Connecting Pipe (Red Power Silencer Only)	1
3	CP1038	Header Pipe	1
Fit Kit - Z039.10646			
4	Z017.10079	M8 x 55mm Cap Head Bolt	1
5	Z026.20068	Alloy Bolt Finisher	1
6	Z026.20309	Ø30 x 10mm Anodised Alloy Spacer	1
7	Z017.10825	M8 Washer	1
8	Z017.10062	M8 Nyloc Nut	1
9	Z028.20264	Open End Internal Flute	1
10	Z028.10030	Rubber Coated Spring	1
11	Z016.10008	43-47mm Band Clamp	1

E-MARK	BSAU 193a 1993t3
DATE	28/02/2019
ISSUE	01
AUTHORISED	J.Harkin

NOTE: ENSURE SCORPION SYSTEM IS CLEAR OF MOVING PARTS AND ALL ORIGINAL FUNCTIONS WORK CORRECTLY.

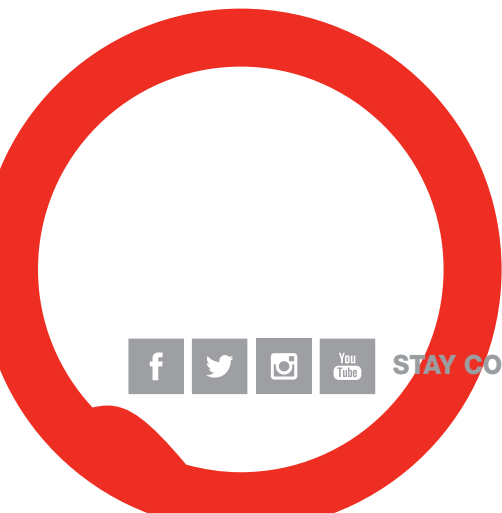

STAY CONNECTED TO RED POWER.

Bike	Yamaha YZF-R125	Part No.	PYA-113-SYS
Year	2019-Current	Fit Kit	Z039.10653
Notes	Where not supplied use original fittings	dB Killer	SCEXDBK49 - (TYPE PD)

Estimated Fitting Time: 60 Minutes



A) Remove original exhaust from bike, taking care to keep all original components in a safe place.

B) Refit Scorpion exhaust as per line diagram above.

C) When fitted take bike for a short ride to ensure all functions are correct.

D) When bike & exhaust are cool enough check all nuts and bolts are still secure.

Thank you for purchasing your Scorpion Silencer.

Care of your exhaust: Please refrain from cleaning silencer with heavy solvents or abrasives!

Vielen Dank Für den kauf eines Scorpion Schalldampfers! Pflegehinweis: Bitte verwenden Sie niemals Scheuermittel oder aggressive Reiniger zur Pflege Ihres Auspuffes!

Merci d'avoir choisi un echappement Scorpion.

Entretien de votre silencieux: Ne pas utiliser de solvants ou de produits abrasifs!

Muchas gracias por adquirir un Silencioso Scorpion. Le recomendamos no limpiar el silencioso con productos abrasivos o aquellos que contengan disolventes.



STAY CONNECTED TO RED POWER.