

ATTENZIONE: Il montaggio del prodotto deve essere eseguito da personale specializzato  
 WARNING: The mounting of the product it must be realized from staff specialist

ESEMPI DI MONTAGGIO CAMBIO STRADALE  
 EXAMPLES OF ROAD SHIFTING ASSEMBLY

B: MONTAGGIO CON ASTA BASSA  
 ASSEMBLY WITH LOW ROD SHIFT

A: MONTAGGIO CON ASTA ALTA  
 ASSEMBLY WITH HIGH ROD SHIFT

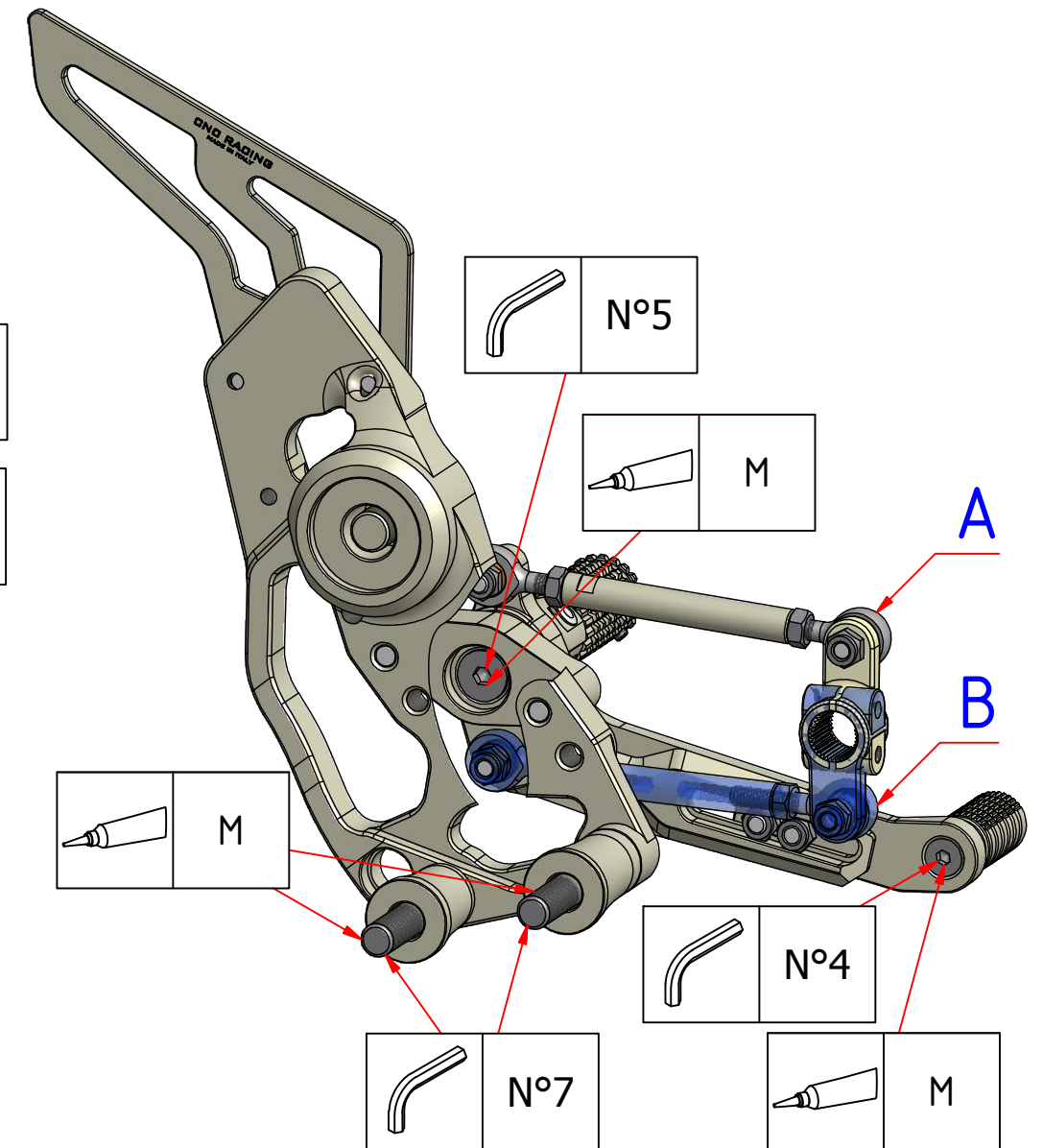
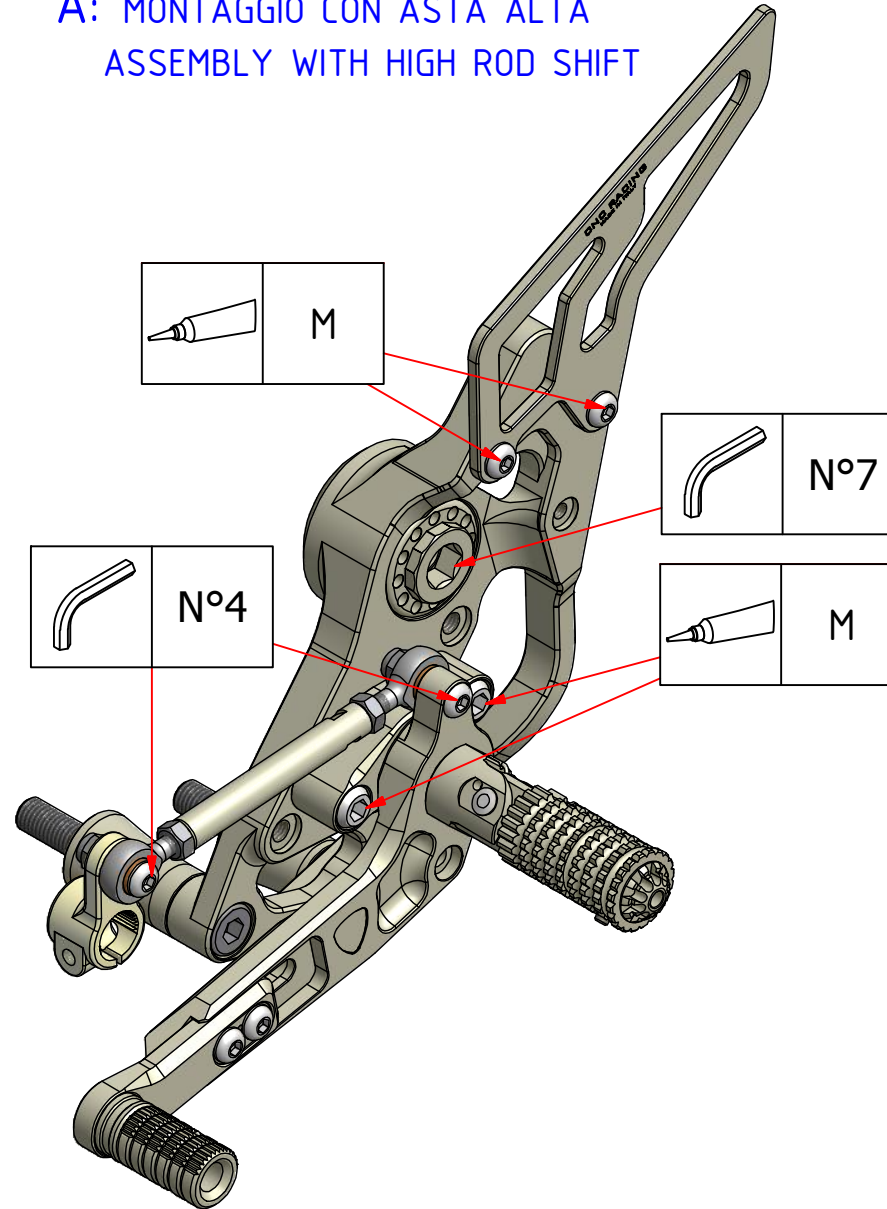
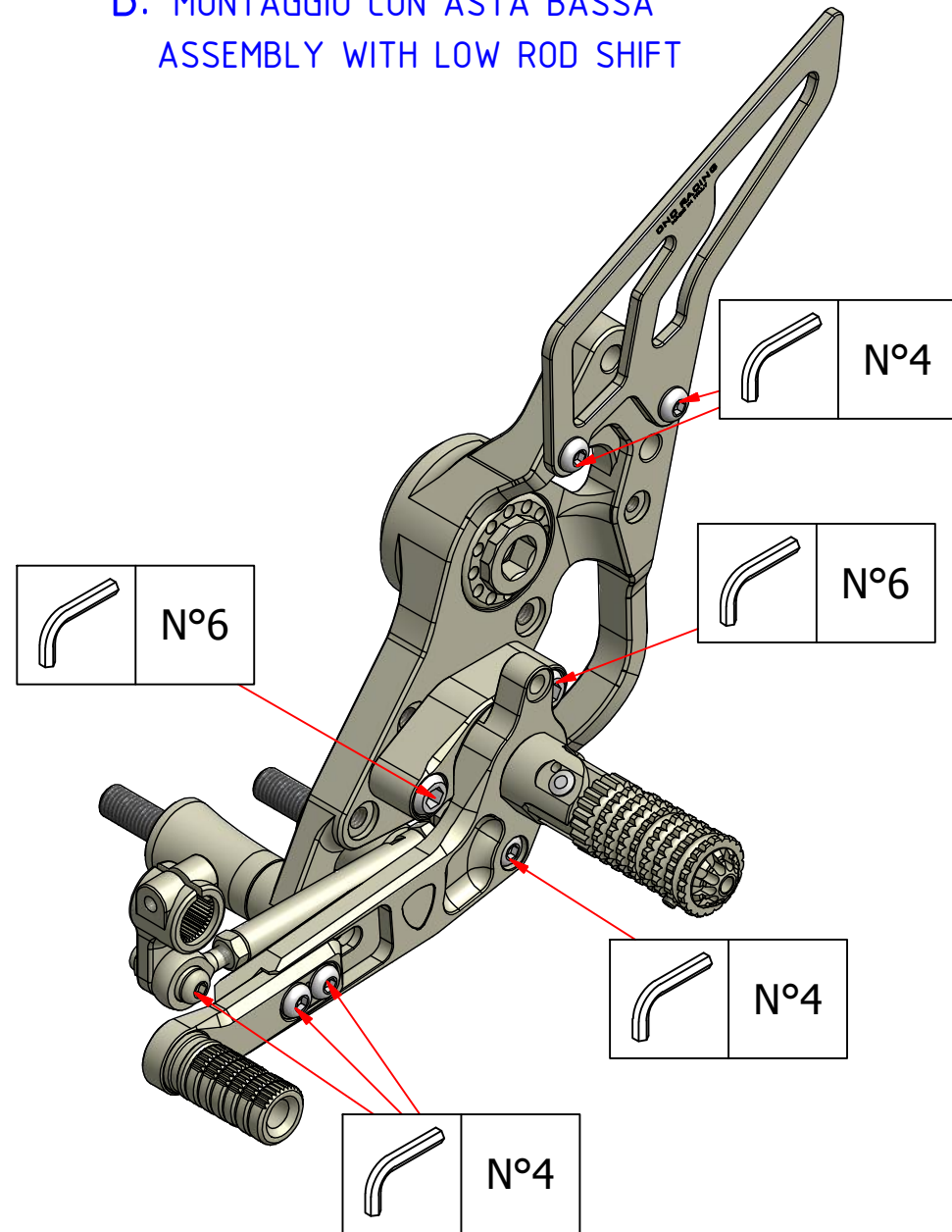

	Pulire e/o sgrassare Clean and/or degrease		Bloccare con frenafilettdi di tenuta: - L= Leggera - M= Media - S= Forte. Lock on with the follow threadlock: L= Light hold - M= Medium hold - S= Strong hold.
--	---	--	---

**ATTENZIONE:** Questo prodotto potrebbe non essere conforme al codice stradale o alle leggi vigenti in alcuni paesi e quindi utilizzabili solo in aree private e/o chiuse al traffico  
**WARNING:** This product may not comply with local road rules and regulations and can be used only in private areas and/or areas closed to traffic.

	ART:	ISTRUZIONI / INSTRUCTION	
	PE430	PEDANA LATO CAMBIO / REAR SET SHIFT SIDE	
	DUCATI	HYPERSTRADA 821 - HYPERMOTARD 821 / 821 SP	

A termini di legge ci riserviamo la proprietà di questo disegno con divieto di riproduzione o di rendimento noto a terzi senza nostra autorizzazione. / Pursuant to law, we reserve the ownership of this drawing with prohibition to copy or disclosed to third parties without our authorization.

ESEMPI DI MONTAGGIO CAMBIO ROVESCOIO  
 EXAMPLES OF REVERSE SHIFTING ASSEMBLY

ATTENZIONE: Il montaggio del prodotto deve essere eseguito da personale specializzato  
 WARNING: The mounting of the product it must be realized from staff specialist

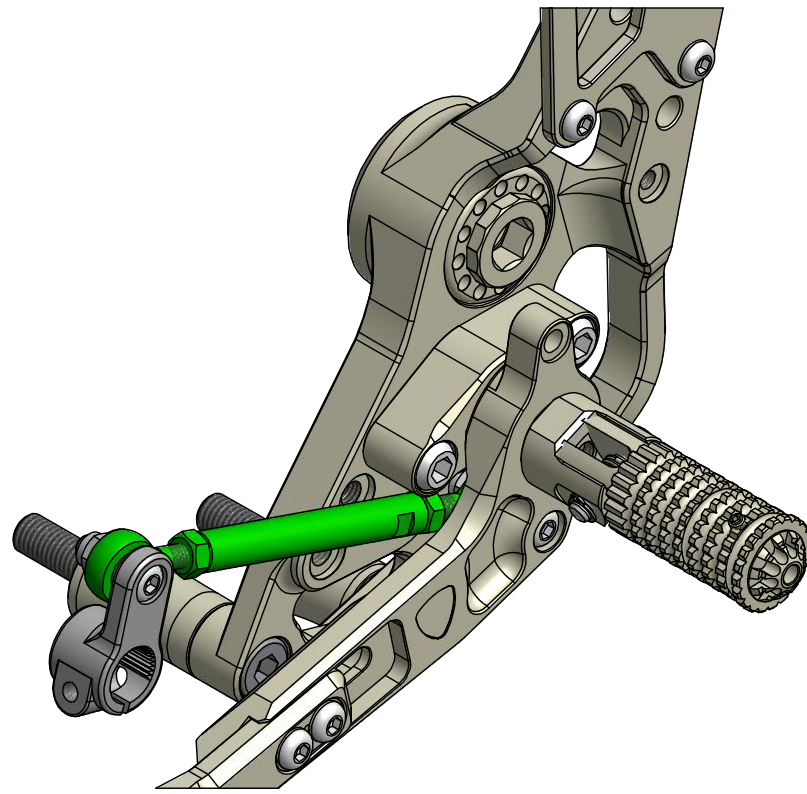

POSIZIONE ALTA  
 HIGH ADJUSTMENT

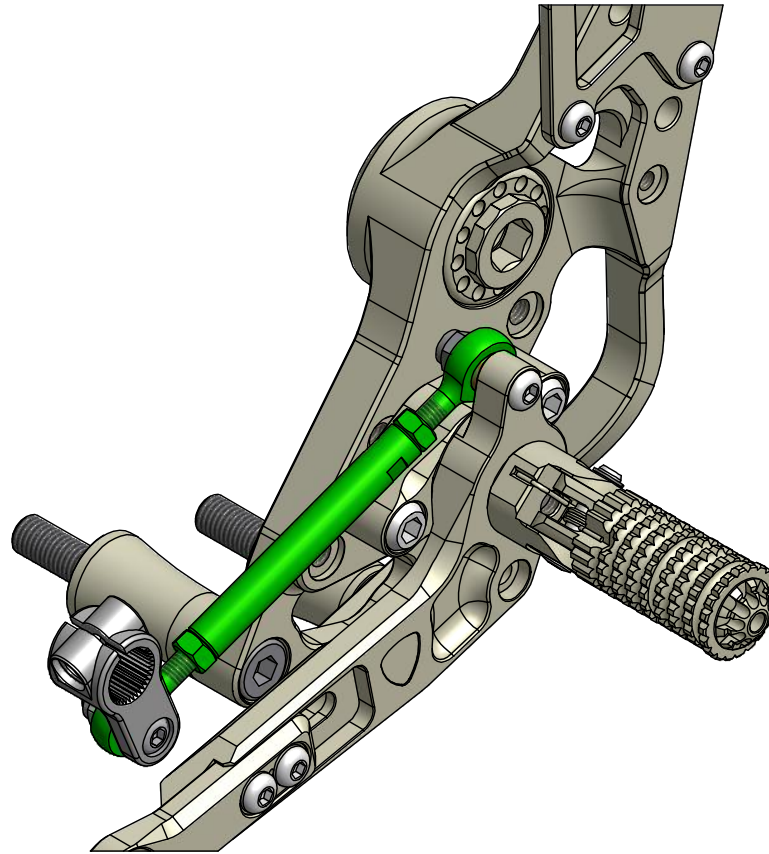

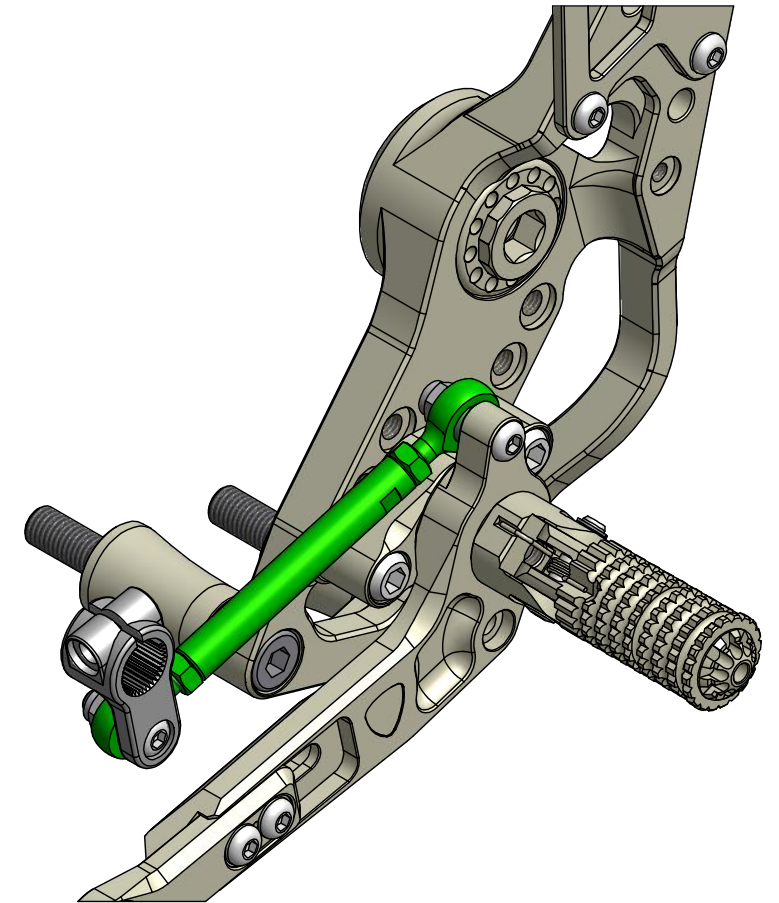

POSIZIONE INTERMEDIA  
 INTERMEDIATE ADJUSTMENT



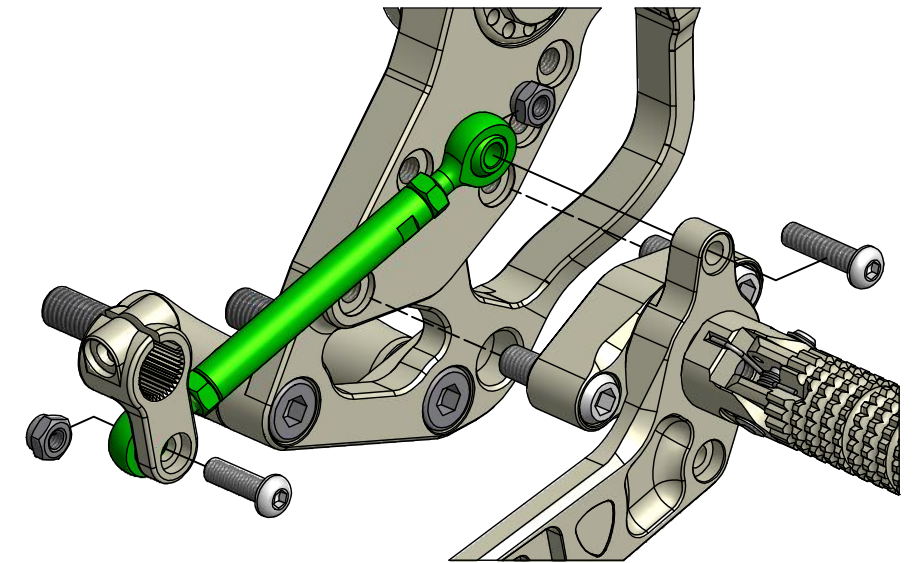
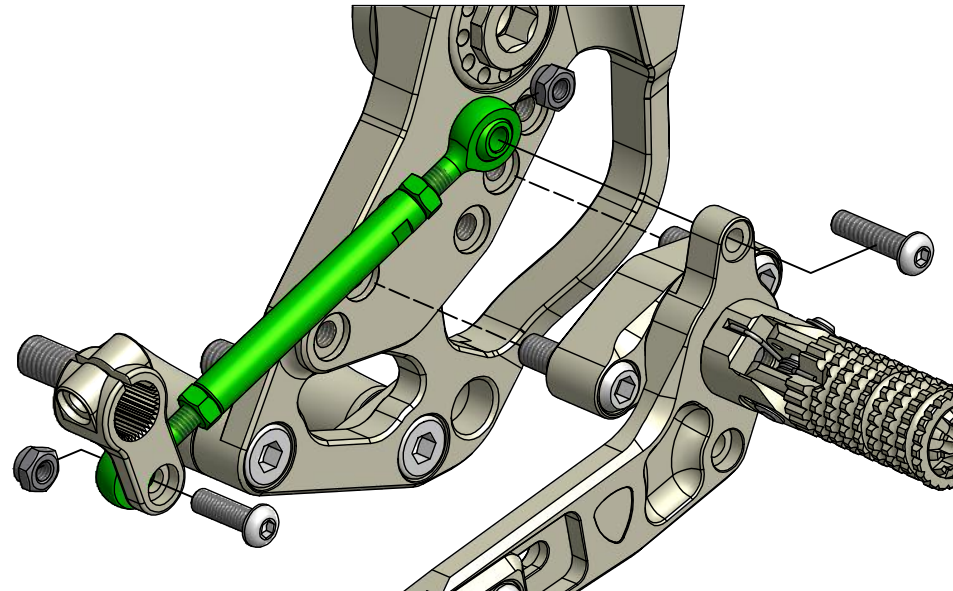
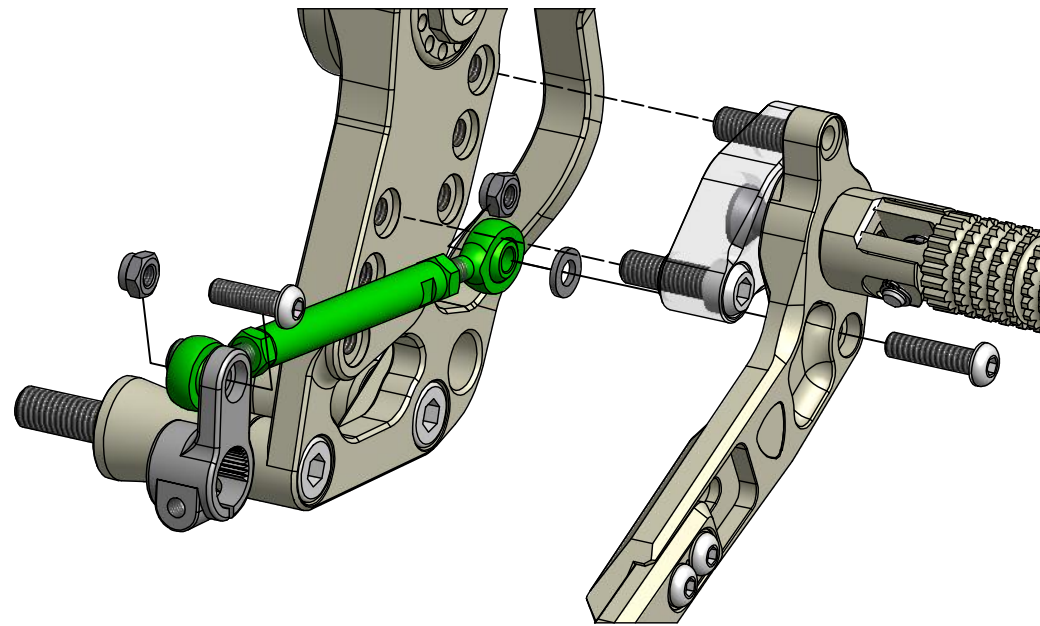

POSIZIONE BASSA  
 LOW ADJUSTMENT



 Pulire e/o sgrassare  
 Clean and/or degrease  Bloccare con frenafilettdi di tenuta: - L= Leggera - M= Media - S= Forte.  
 Lock on with the follow threadlock: L= Light hold - M= Medium hold - S= Strong hold.

 **ATTENZIONE:** Questo prodotto potrebbe non essere conforme al codice stradale o alle leggi vigenti in alcuni paesi e quindi utilizzabili solo in aree private e/o chiuse al traffico  
**WARNING:** This product may not comply with local road rules and regulations and can be used only in private areas and/or areas closed to traffic.

	ART:	ISTRUZIONI / INSTRUCTION	
	PE430	PEDANA LATO CAMBIO / REAR SET SHIFT SIDE	
			

A termini di legge ci riserviamo la proprietà di questo disegno con divieto di riproduzione o di rendimento noto a terzi senza nostra autorizzazione. / Pursuant to law, we reserve the ownership of this drawing with prohibition to copy or disclosed to third parties without our authorization.