

Thank you for purchasing a National Cycle product. Read these instructions carefully and thoroughly before beginning work. Dealers, if installing this windscreen for a customer, please give them this manual. It contains information needed to properly maintain and use this product.



Attention:

Special notes and cautionary measures which can prevent damage to the accessory or motorcycle.



Note:

Tips for facilitation of operation, control and adjustment, as well as maintenance work.

CONTENTS OF KIT

Item	Description	Part No.	Qty.	Notes
1	Luggage Rack	37-374448-000	1	
2	Bracket	37-374449-000		Assembled to Rack
3	Screws, M8 x 16 SS	51-516415-000		Assembled to Rack

Bag#1124

4	Screws, M6-1.0 x 40 SS	51-515272-000	4	
5	Washer, Split	49-491110-000	4	

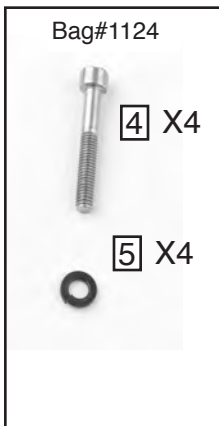

TOOLS

5mm Hex Wrench



Figure 1

PREPARATION

1. Place motorcycle securely on its side stand.
2. Remove the stock passenger seat and lift tray. **Figure 1**

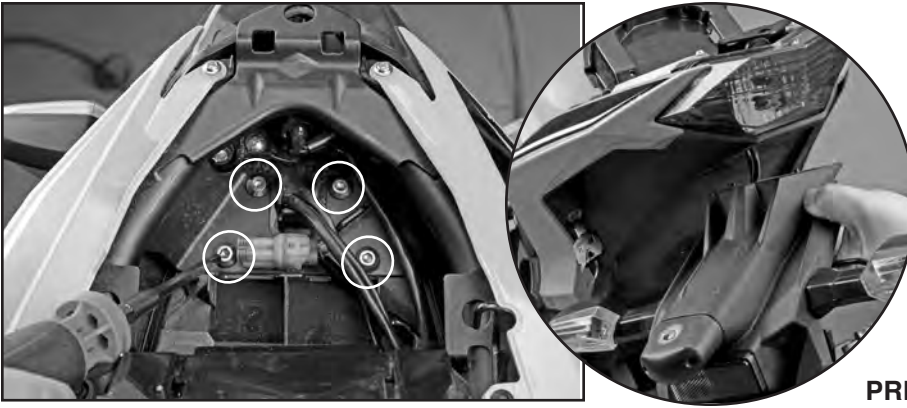

Figure 2

PREPARATION

3. Remove the 4 screws holding the turn signal / license plate bracket assembly. **(5mm Hex Wrench) Figure 2**

INSTALLATION

1. Place Rack Assembly (1 and 2) on motorcycle. **Figures 3, 4 and 5**



a. The Slot in Bracket (2) is a Wire Guide. **DO NOT BIND WIRES.**

b. Align positioning nub on tail light with hole in Bracket (2).

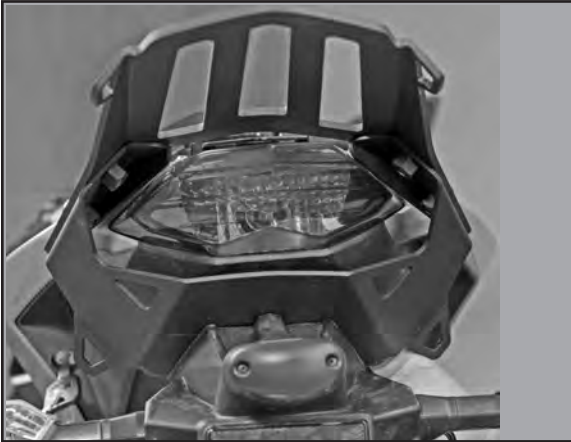

Figure 3

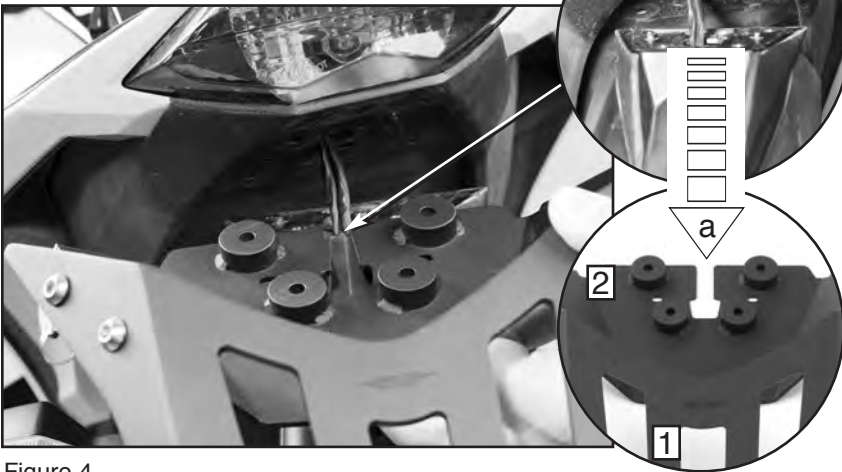

Figure 4

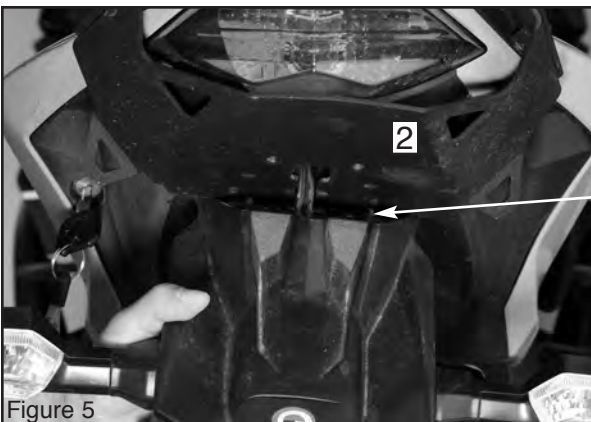

Figure 5

INSTALLATION

2. Install Rack with Screw (4) and Washer (5). Repeat at all four locations. (5mm Hex Wrench) Figure 6

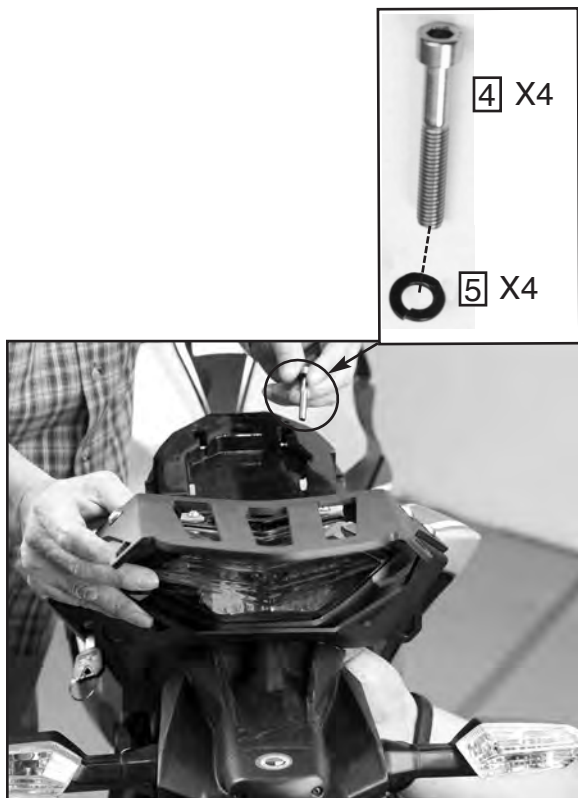

Figure 6

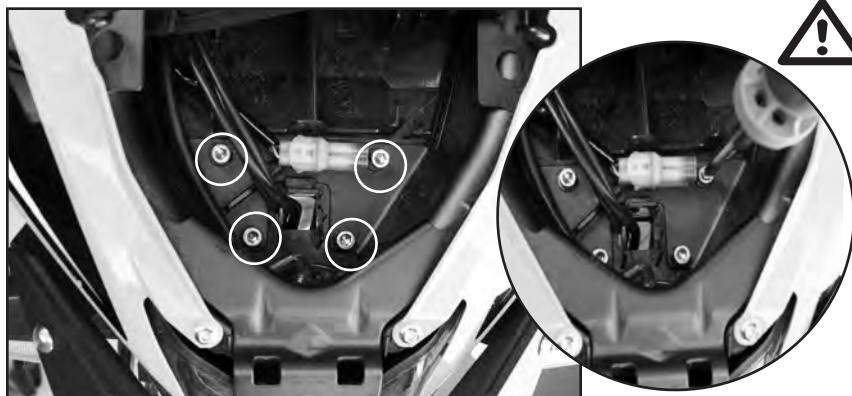

Figure 7



3. Tighten Screws Firmly. 7ft-lbs (7.5 Nm) torque. (5mm Hex Wrench, Torque Wrench) Figure 7

Re-torque fasteners periodically.

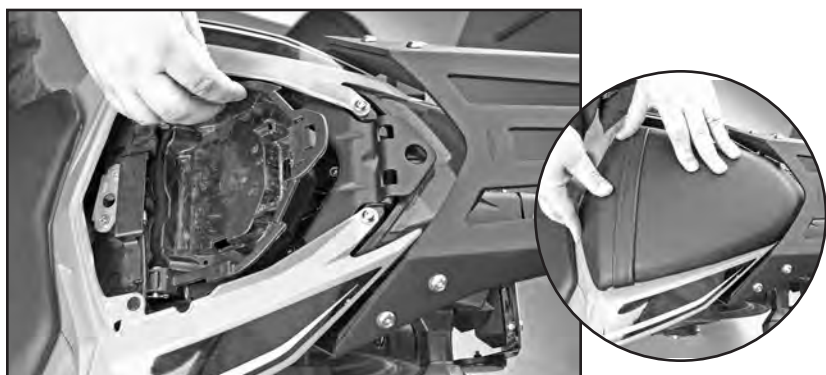

Figure 8

4. Re-install tray and seat. Figure 8

CLEANING AND MAINTENANCE

To clean the rack, wash with a clean soft cloth, plenty of warm water and if necessary, a non-abrasive soap such as dishwashing liquid. Flannel or soft chamois make good cleaning cloths.



DISASSEMBLING RACK

The Rack (1) and Bracket (2) are factory assembled using the M8 x 16 (3) screws with a small amount of thread locker (Loctite® 234 or medium strength comparable.) If you remove the M8 x 16 screws, re-apply a small amount of thread locker on each of the screws before re-assembling.



M8 x 16

Thread Lock

LOADING THE RACK

Keep your gear away from tail light and brake light as shown (A).



Do not block tail light or brake light with your gear. (B).

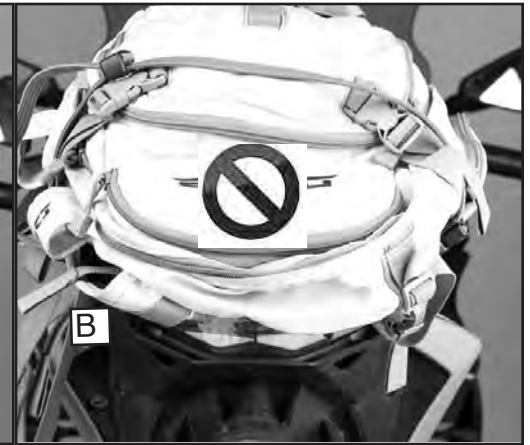
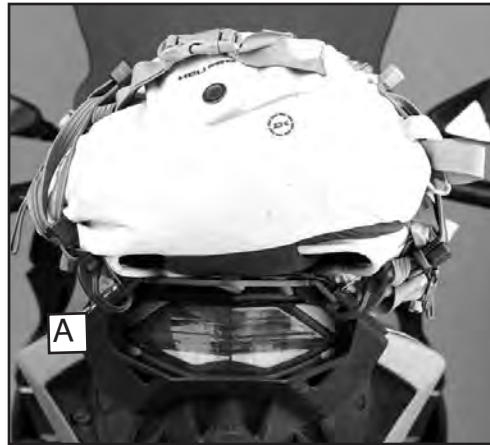

! WARNING

Never ride your motorcycle with loose accessory mounting hardware. Check the hardware for tightness regularly.

Today's motorcycles are built with enough frame rigidity to withstand the moderate loads imposed on them by the foreseeable addition of an accessory(ies). If an accessory(ies) adversely affects your motorcycle's stability, immediately remove the accessory(ies). Do not ride a motorcycle that exhibits unsafe handling traits.

Have experienced service personnel correct any problem before riding with the accessory(ies) installed. For further questions concerning handling problems associated with an accessory(ies), contact your dealer, motorcycle manufacturer, or accessory manufacturer.

Load capacity 10 lbs. (4.5kgs) load.

Do not block taillight or brake light with your gear.

National Cycle, Inc. PO Box 158 Maywood, IL 60153-0158 USA

708-343-0400 / Fax: 708-343-0625 / www.nationalcycle.com / e-mail: info@nationalcycle.com