

Thank you for purchasing a National Cycle product. Read these instructions carefully and thoroughly before beginning work. Dealers, if installing this luggage rack for a customer, please give them this manual. It contains information needed to properly maintain and use this product.



Attention:

Special notes and cautionary measures which can prevent damage to the accessory or motorcycle.



Note:

Tips for facilitation of operation, control and adjustment, as well as maintenance work.

CONTENTS OF KIT

Item	Description	Part No.	Qty.	Notes and Tools
1	Luggage Rack		1	Available in Chrome or Black Finish
Bag#1209				
2	Spacer, Rear Upper	34-342917-000	1	
3	Spacer, Rear Lower	34-342918-000	1	
4	Screw, Flat, M8 x 25 SS	51-514331-000	1	5mm Hex Wrench
5	Screws, Button M8 x 20	51-516421-000	2	5mm Hex Wrench

Bag#1209

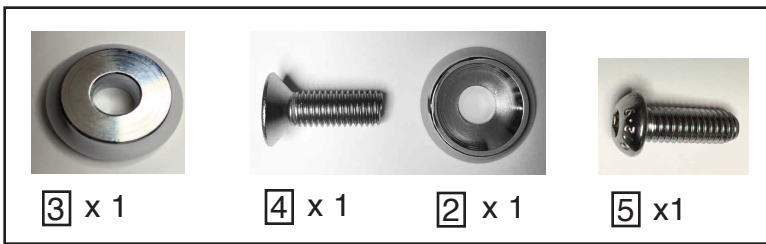

TOOLS

13 mm Socket or Box Wrench for removal of seat
5mm Hex Wrench



Figure 1

PREPARATION

1. Place motorcycle securely on its side stand.
2. Refer to the Owner's Manual, to remove the rider's seat.
3. Remove the stock passenger seat (if applicable.) (5mm Hex Wrench and 13mm Socket or Box Wrench) Figure 1

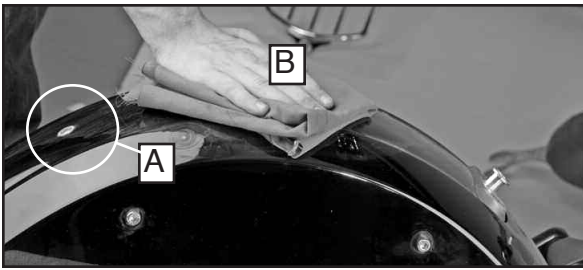

Figure 2

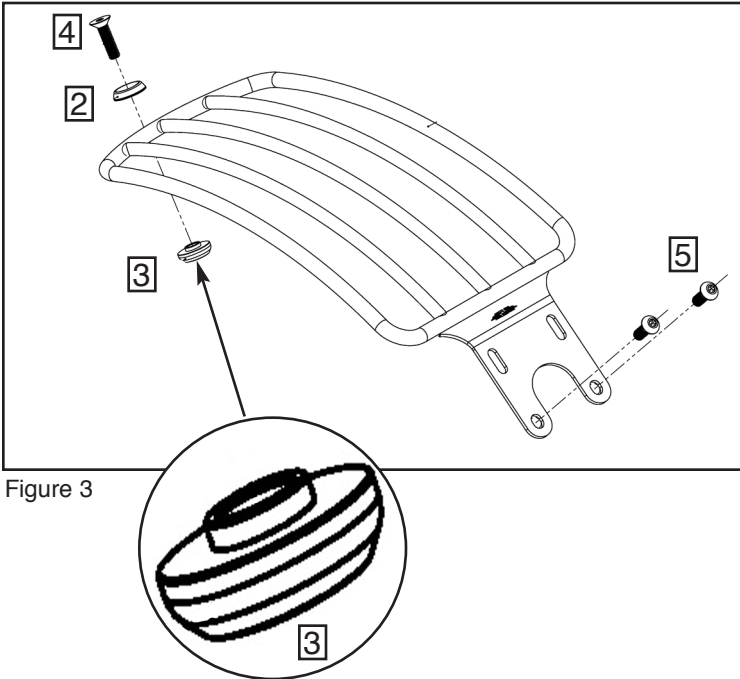

Figure 3



Figure 4



Figure 5

PREPARATION

4. Before installing the Rack:

A. Remove the plastic plug from the rear mounting nut if you do not currently have a passenger seat installed.

B. Clean the rear fender.

Figure 2

INSTALLATION

 **Use caution- place a towel or cloth over the rear fender during installation to avoid accidental scratches.**

Install Rack at Front Location

1. Carefully place the rack on the rear fender. Loosely install Rack at front location using the 2, Button Head Screws (5).
(5mm Hex Wrench) Figure 3 and 4

Install Rack at Rear Location

2. Insert the Flat Head Screw (4) through the Upper Spacer (2). Place Spacer (3), with neck facing up, between rack and motorcycle.
Figure 3

3. Loosely install Rack with the Flat Head Screw Assembly. **(5mm Hex Wrench) Figure 3 and 4**

Final Adjustment

4. Adjust Rack, and tighten all Screws firmly.
(5mm Hex Wrench)

5. Re-install the rider seat according to the instructions in your Owner's Manual. **Figure 5**

CLEANING AND MAINTENANCE

To clean the rack, wash with a clean soft cloth, plenty of warm water and if necessary, a non-abrasive soap such as dishwashing liquid. Flannel or soft chamois make good cleaning cloths.

WARNING

Never ride your motorcycle with loose accessory mounting hardware. Check the hardware for tightness regularly.

Today's motorcycles are built with enough frame rigidity to withstand the moderate loads imposed on them by the foreseeable addition of an accessory(ies). If an accessory(ies) adversely affects your motorcycle's stability, immediately remove the accessory(ies). Do not ride a motorcycle that exhibits unsafe handling traits.

Have experienced service personnel correct any problem before riding with the accessory(ies) installed. For further questions concerning handling problems associated with an accessory(ies), contact your dealer, motorcycle manufacturer, or accessory manufacturer.

Load capacity 10 lbs. (Kg) load.

Do not block taillight or brake light with your gear.

Visit your dealer or our web site to see the complete range of products we manufacturer for the Indian Scout.



N7048, cast front Fender Tips, 2 piece set



N2531, FlyScreen®



N21605, WaveQR®

National Cycle, Inc. PO Box 158 Maywood, IL 60153-0158 USA

708-343-0400 / Fax: 708-343-0625 / www.nationalcycle.com / e-mail: info@nationalcycle.com