

SITZBANK

Seat | Asiento | Selle | Sella

Art.-Nr: 44118-00x

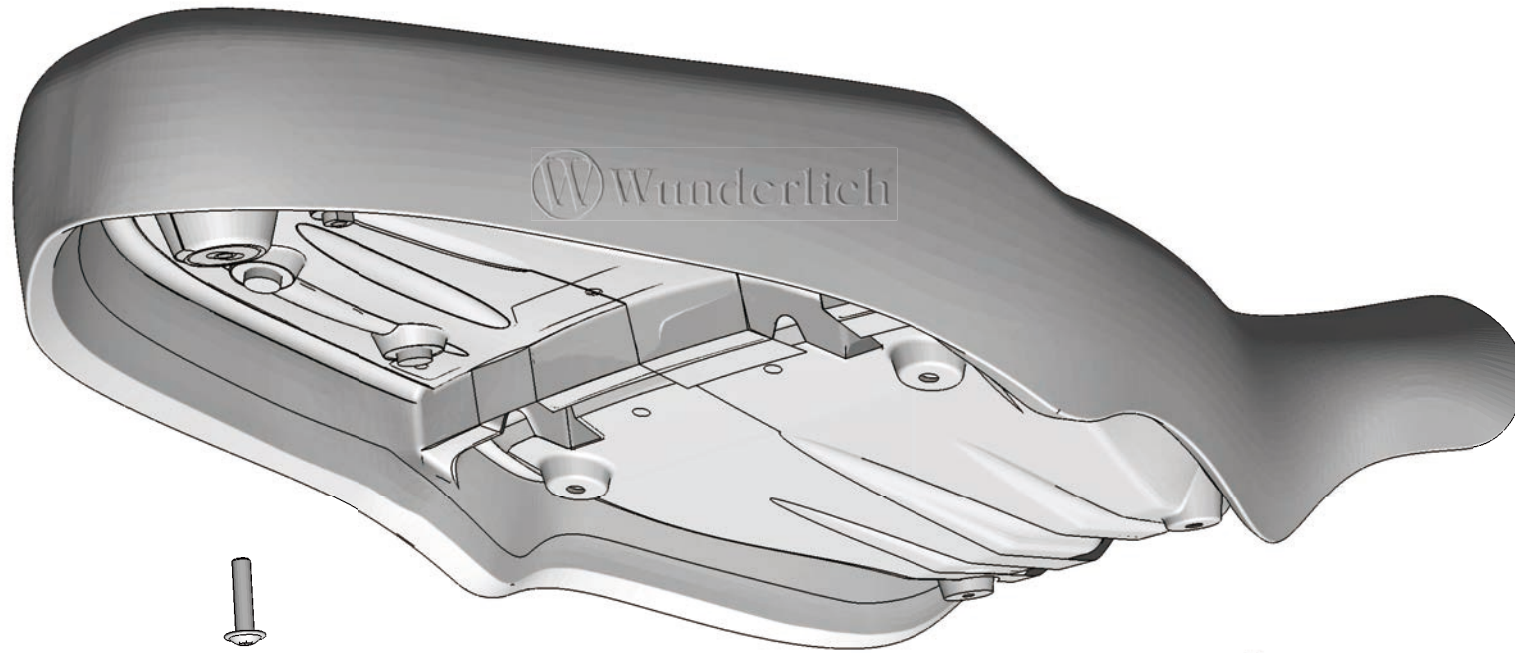

PIA International
Peitzmeier Co.

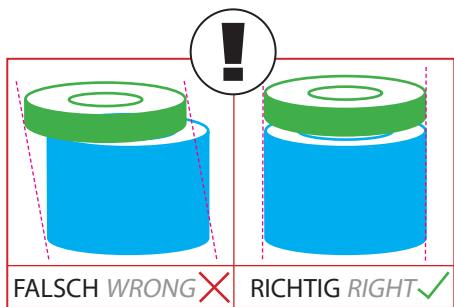

#	BEZEICHNUNG	MENGE
1	Linsenkopfschraube M6 x 25	2
2	U-Scheibe 9021SA2-6	2
3	Distanzhülse D 18,0-d 8,5-h 13,5mm	2
4	Halteblech	1
5	U-Scheibe 125SA2-6	2
6	Sechskantmutter M6	2
7	Linsenflanschschraube M6 x 35 8Nm	2
8	Sitzbank	1
9	Linsenflanschschraube M6 x 25	1

LEGENDE / KEY

Anbau Tipp
Fitting tip

Achtung
Attention

Vergrößerung
Magnification

Schraube
Screw

Schraubensicherung
Thread locking fluid

M10x14
15Nm
Drehmoment
Tourque

PIA International
Peitzmeier Co.

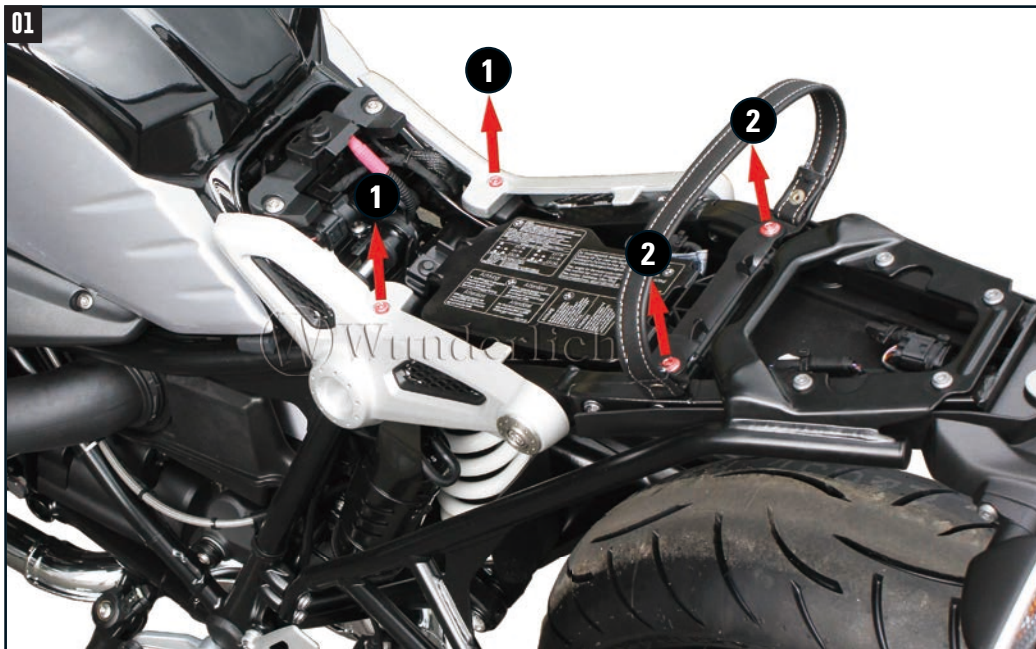

01 Vorab original Sitzbank demontieren. Schrauben 1 und 2 entfernen, Pos. 2 entfällt.
Disassemble the original seat in advance. Remove screws 1 and 2, Pos. 2 is omitted.

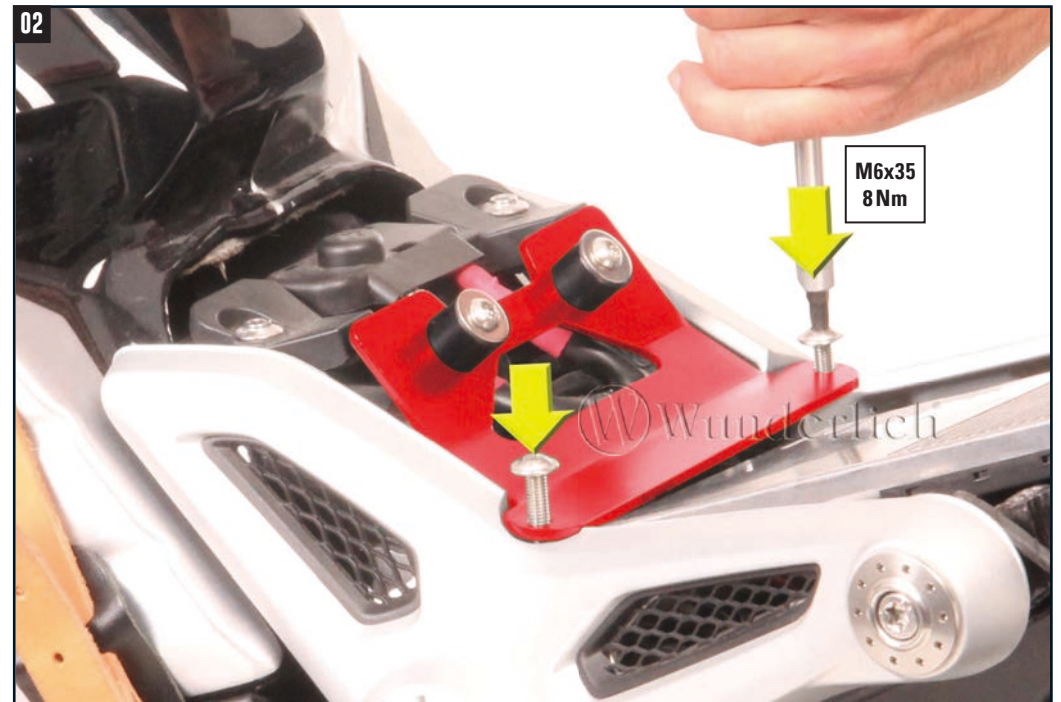

03 Sitzbank vorne in die 2 Führungbolzen einschieben und hinten wieder verschrauben.
Insert the seat in the front of the 2 guide bolts and screw the seat back on again.