



Instruction Manual for Aluminum Swing Arm (4-cm-longer type)

Item No : 0 6 - 0 3 - 0 1 0 1

Applicable model names and the frame Nos:

Monkey · Gorilla (6V) : Z50J-1300017 ~ 1805927

Monkey · Gorilla (12V) : Z50J-2000001 ~

: AB27-1000001 ~

Monkey (FI)

: AB27-1900001 ~

- Thank you for purchasing one of our TAKEGAWA's products. You are requested to follow the below-mentioned instructions in installing this Kit.
- Before installation, please check the contents of this Kit. Should you have any questions about the product, please kindly contact your local dealer.

Please note that the descriptions in this manual like illustrations and photos may differ from the actual hardware.

Please read the following instructions before installation.

We do not take any responsibility for any accident or damage whatsoever arising from the use of the products not in conformity with the instructions in the manual.

We shall be held free from any kind of warranty whatsoever of products other than this product if the glitch takes place on the other products than this one after the installation and use of this product.

You are kindly requested not to contact us about the combination of our products with other manufacturers'.

This product is designed for exclusive use in the above-mentioned types of motorcycles and frame numbers only. Please take note that this product cannot be mounted on other types of motorcycles.

For installation, please prepare suitable tools and work with reference to the installation instructions with enough care. Besides, this instruction manual and Honda's genuine service manuals are prepared with those in mind who have basic skills and knowledge. Therefore, we recommend those who have never installed the parts or those who do not have sufficient tools to ask a technically-reliable speciality shop for the work.

In placing a repair parts order with us, please quote the Repair Parts Item Nos. Should you have any questions about the repair parts, please contact your local motorcycle dealer.

Before starting the installation, please read this Instruction Manual well for your thorough understanding and proper installation.

Features

We have designed and produced this swing arm, fully utilizing the know-how obtained through the development of the MONKEY and the GORILLA over many years.

The unsprung weight-saving and the combined use of this swing arm with a 280mm rear shock absorber have made the swing arm more stable than the standard ones. As this swing arm is only 4 cm longer than the standard ones, you can use the rear fender and other parts as they are. Thus, even after the installation of this product, the original form can still be maintained.

A genuine chain case cannot be installed.

For the installation of this product, you are required to replace the rear shock absorber with that of 280 mm.

You are required to separately prepare a drive chain which has more links.

A 10inch wheel cannot be installed.

CAUTION The following show the envisioned possibility of injuries to human bodies or property damage as a result of disregarding the following cautions.

- Always use a torque wrench to screw bolts and nuts tight and securely to the specified torque.
(Improper torque could cause these parts to get damaged or fall off.)
- Work only when the engine and the muffler are cool. (Otherwise, you will burn yourself.)
- Prepare right tools for the work, and do the work in the proper and right way.
(Otherwise, improper work could cause breakage of parts or injuries to yourself.)
- As some products and frames have sharp-pointed or protruding portions, please work with your hands protected. (Otherwise, you will suffer injuries.)
- Before riding, always check every section for slack in parts like screws. If you find slack ones, screw them securely up to the specified torque.
(Or improper torque may cause parts to come off.)

WARNING The following show the envisioned possibility of human death or serious injuries to human bodies as a result of disregarding the following cautions.

- Before doing work, place the motorcycle on level ground to stabilize the position of your motorcycle for safety's sake.
(Otherwise, your motorcycle could fall down and injure you while you are working.)
- When you notice something abnormal with your motorcycle while riding down a road, stop riding immediately and park your motorcycle in a safe place.
(Otherwise, the abnormality could lead to an accident.)
- Check or perform maintenance of parts correctly according to the procedures in the instruction manual or a service manual.
(Improper checking or maintenance could lead to an accident.)
- If you find damaged parts when checking and performing maintenance, do not use these parts any longer, and replace them with new ones.
(The continued use of these damaged parts as they are could lead to an accident.)
- Keep plastic bags for packing the products out of children's reach, or discard them. (If children get them on, there will be a danger of their suffocating.)
- Keep the brake drum and brake shoe clean of oil or grease. If any oil or grease adheres to them, replace the brake shoe with a new one and degrease the brake drum. (Otherwise, the adherence may lead to an accident.)

Please be informed that, mainly because of improvement in performance, design changes, and cost increase, the product specifications and prices are subject to change without prior notice.

This manual should be retained for future reference.

~ Kit Contents ~

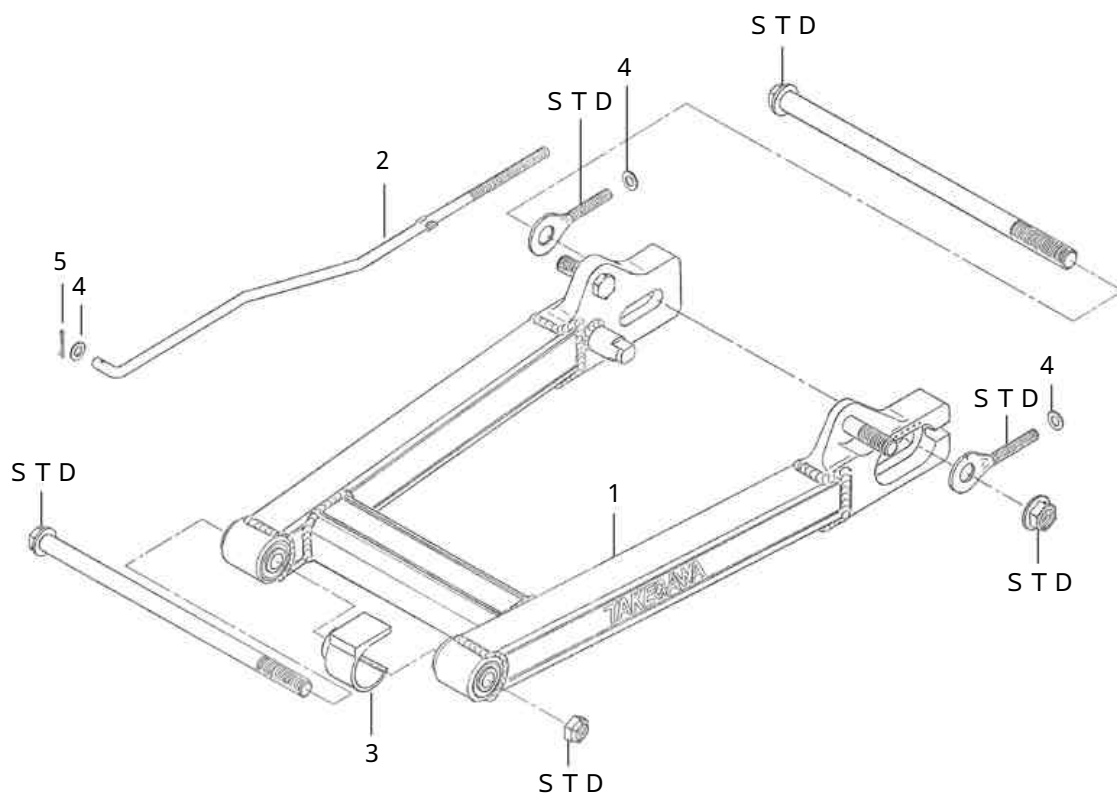

No.	Parts Name	Qty	Repair Part Item No.	In packs of
1	Swing arm COMP.	1	_____	1
2	Brake rod	1	43451-165-T23	1
3	Chain slider	1	00-06-0010	1
4	Plain washer, 6 mm	3	00-00-0086	10
5	Split pin, 1.6 x 25	1	00-06-0018	10
	Plain washer, 10 mm	2	00-00-0151	10

Please note that in ordering repair parts, be sure to quote the Repair Part Item No. Otherwise, we may not be able to accept your orders. There are some parts, however, for which we are not in a position to accept your order in just the quantity to be used. In this case, please take them in the quantity packed.

~ Installation Procedures ~

Check the kit contents.

Prepare proper tools for the installation work, and stabilize the vehicle securely.

⚠WARNING : Make sure your motorcycle is secure on level ground during installation.

Remove a rear-brake-adjusting nut to remove a brake rod.

Remove a rear axle nut to pull out an axle shaft.

Detach a drive chain from the driven sprocket to demount a rear wheel.

Remove a shock absorber.

Remove a pivot nut on the rear fork, pull out the pivot shaft and remove a rear fork.

Detach a clip on the drive chain and remove the chain.

Attach a chain slider from within to a pivot on the chain side in the swing arm COMP., and install the swing arm to the frame, and loosely tighten for now the pivot shaft.

Place a 280mm shock absorber upright. Holding a hexagonal bolt on the rear side with a screw wrench, tighten it to the specified torque.

⚠Caution: Never fail to observe the specified torque.

Torque : 25 ~ 35 N · m (2.5 ~ 3.5 kgf · m)

This is the case where a Z-style muffler is in use. To install a right-side shock absorber or on the side of the brake panel, put a 10mm brake washer between the swing arm and shock absorber on both top and bottom sides. And position the shock absorber and install it with a standard washer.

In the case of a Z-style muffler:

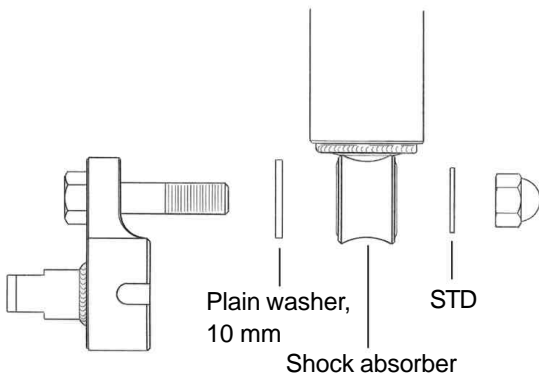

In the case of only a right-side shock absorber:

If a down muffler is in use, install the right-side shock absorber with a 10mm plain washer. Do not use a standard washer.

In the case of a down muffler and others:

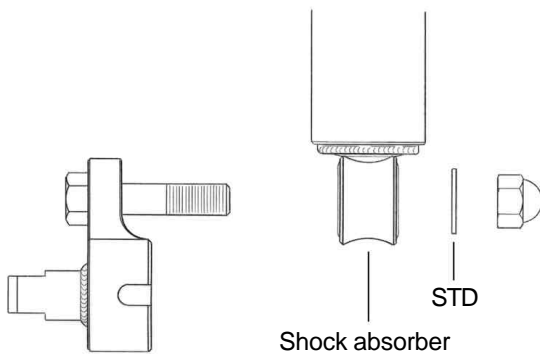

In the case of only a right-side shock absorber:

Tighten the nut on the pivot shaft to the specified torque.

⚠Caution: Never fail to observe the specified torque.

Torque : 25 ~ 35 N · m (2.5 ~ 3.5 kgf · m)

Apply a thin coat of grease to the rear axle shaft, and place a chain adjuster at each side. And install a rear wheel and tighten a rear axle nut loosely for now.

⚠WARNING: Keep the lining surface inside the brake drum clean of any oil or grease. If any oil or grease adheres, degrease the brake drum and replace the brake shoe with a new one.

Place a chain, which has many links, on the sprocket, and cut it with a chain cutter to match the sprocket.

⚠Caution: Attach the clip onto the drive chain in the right direction.

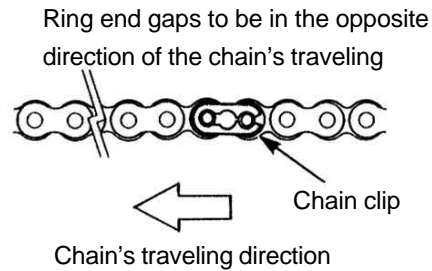

Adjust the tension on the drive chain. Attach a nut to the chain adjuster just the way you do with a standard chain. (When installing onto the FI Monkey, attach an included plain washer and a nut to the chain adjuster.)

Adjust the tension of the drive chain to have about 10 to 20 mm of free play when measured at a midway point between two sprockets.

⚠Caution: Set the alignment marks on both chain adjusters on the right and left at the same scale marks.

Tighten the rear axle nut to the specified torque.

⚠Caution: Never fail to observe the specified torque.

Torque : 40 ~ 50 N · m (4.0 ~ 5.0 kgf · m)

Tighten up the chain-adjusting nut.

Attach a brake rod, and adjust the free play at a rear brake pedal by turning the adjusting nut to the right and left.

Free play: 10 to 20 mm

Double-check the tightening torque of the related parts and the free-play ranges, and wipe off dirt or dust on the parts.

SPECIAL PARTS TAKEGAWA Co.,Ltd.

3-5-16 Nishikiorihigashi Tondabayashi Osaka Japan

TEL : 81-721-25-1357 FAX : 81-721-24-5059

URL : <http://www.takegawa.co.jp>